

## 6 Paradise Street, Rhyl

£155,000

🛏 4 🚿 1 🛋 2



This spacious Edwardian terraced property, set over three floors, is a fantastic opportunity for those looking to put their own stamp on a home. With 2 reception rooms and 4 bedrooms, there is plenty of space for a growing family. The high ceilings and fireplaces create a warm and inviting atmosphere, providing ample space for both living and dining purposes. The bedrooms are thoughtfully arranged, with double master bedroom, the remaining bedrooms comprise of two singles and a double, providing flexibility for various needs and preferences. The property benefits from a well-sized kitchen and a bathroom, allowing for comfortable daily living. With a little bit of modernisation, this presents an exciting opportunity to create a bespoke living environment to suit your personal taste and style. Conveniently located with easy access to public transport links, in walking distance of the main town centre, providing access to a range of shops, restaurants, and leisure facilities.

- Terraced property
- Two spacious reception rooms
- Edwardian property
- Walking distance to town
- EPC - D / Council tax - C
- Four bedrooms
- Fireplaces and high ceilings
- Convenient location
- Freehold
- Date - 09/11/2023

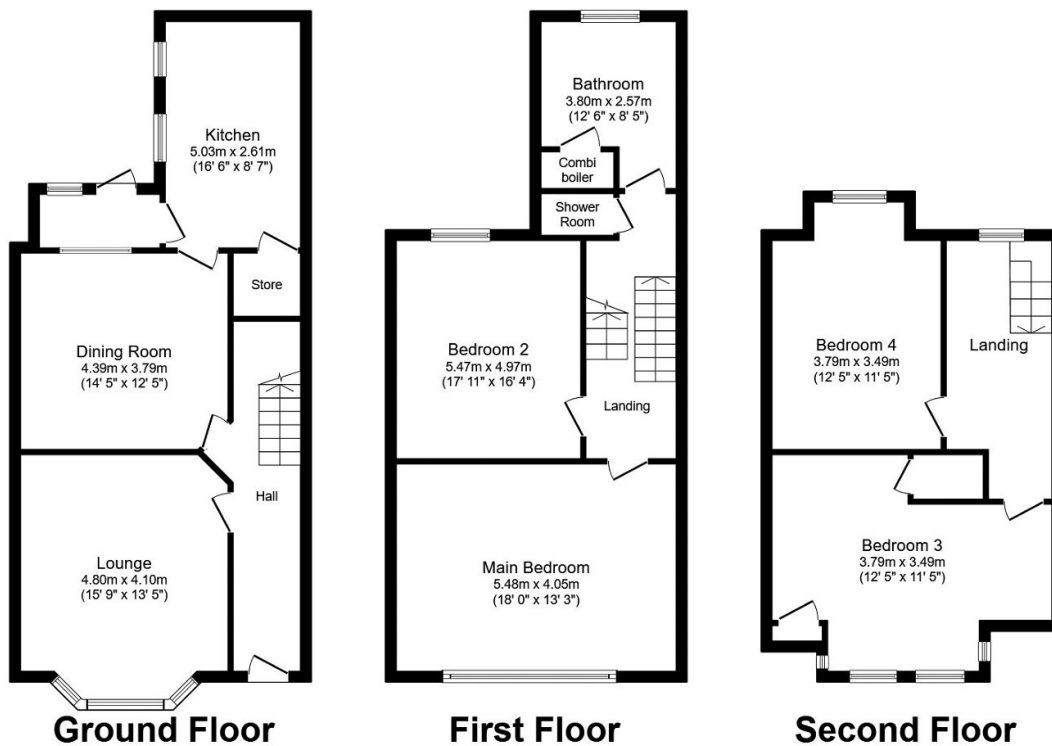

Total floor area 159.3 m<sup>2</sup> (1,714 sq.ft.) approx

This plan is for illustration purposes only and may not be representative of the property. Plan not to scale. Powered by PropertyBox